



AUSTRALIA'S ONLY
INTEGRATED MINING
AND ENERGY
INVESTMENT FORUM



THE MINING 2008 RESOURCES CONVENTION

29-31 OCTOBER, 2008

HILTON BRISBANE HOTEL
QUEENSLAND - AUSTRALIA

CONFERENCE PROGRAM

BRISBANE

... THE TRADITION CONTINUES



Day 1 - WEDNESDAY 29 OCTOBER, 2008

AUDITORIUM 1

- 8.40am **Welcome Address**
Stewart McDonald - Managing Director
Vertical Events
- 8.45am **Official Opening Address**
Hon Anna Bligh MP
Premier of Queensland
- 9.00am **Market Update**
Mark Simpson - Head of Research
Patersons Securities Limited
- 9.20am **Will Inflation Bring the Mining Boom to an End?**
Justin Smirk - Senior Economist
Westpac Institutional Bank
- 9.40am **CRU Mineral Commodities Outlook - Red Hot or Stone Cold?**
Allan Trench - Regional Director, Australasia
CRU | Analysis
- 10.00am **Energy in Australia: Recent Developments and Future Prospects**
Paul Balfe - Executive Director
ACIL Tasman Pty Ltd
- 10.20am Morning Tea**
- 11.00am **Queensland Energy Exploration Expansion**
Peter Green - Manager Exploration Strategies
Department of Mines and Energy, QLD
- 11.15am **Smart Exploration Successes**
David Mason - Executive Director,
Geological Survey of Queensland
Department of Mines and Energy, QLD
- 11.30am **New Insights into the Controls on Zn-Pb, Cu and U Mineralisation in the Mt Isa and Georgetown Inliers**
Dr David Huston - Project Leader, Onshore Energy and Minerals Division
Geoscience Australia
- 11.55am **Lihir Gold Limited**
Graham Folland - General Manager Corporate Development
- 12.15pm **Western Areas NL**
Julian Hanna - Managing Director
- 12.35pm Lunch**
- 1.40pm **Matrix Metals Limited**
Shane McBride - Managing Director
- 2.00pm **Auzex Resources Limited**
John Lawton - Executive Chairman
- 2.10pm **Australasian Resources Limited**
Andrew Caruso - Managing Director
- 2.30pm **Integra Mining Limited**
Chris Cairns - Managing Director
- 2.50pm **Alliance Resources Limited**
Steve Johnston - Chief Executive Officer
- 3.10pm Afternoon Tea**
- 3.50pm **Trafford Resources Limited**
Ian Finch - Managing Director
- 4.10pm **Krucible Metals Limited**
Tony Alston - Managing Director
- 4.30pm **CopperCo Limited**
Brian Rear - Managing Director
- 4.50pm **WildHorse Energy Limited**
Richard Pearce - Chief Executive Officer
- 5.10pm **PanAust Limited**
Dr Fred Hess - Executive General Manager Southeast Asia
- 5.30pm **Conference Drinks in the Exhibition Area**
- 6.30pm **Patersons Securities Cocktail Party**
Jade Buddha Shadow Lounge

AUDITORIUM 2

- 11.00am **The Great Years Ahead**
Helen Sava - National Secretary
Association of Independent Retirees
- 11.15am **Resources - Where to Now?**
Grant Craighead - Managing Director
Stock Resource
- 11.35am **BC Iron Limited**
Mike Young - Managing Director
- 11.55am **Gunson Resources Limited**
David Harley - Managing Director
- 12.15pm **Image Resources NL**
George Sakalidis - Managing Director
- 12.35pm Lunch**
- 1.40pm **Laramide Resources Limited**
Rob Sowerby - Senior Project Geologist
- 2.00pm **Venture Minerals Limited**
Andrew Radonjic - Managing Director
- 2.10pm **Warwick Resources Limited**
Bruce McQuitty - Managing Director
- 2.30pm **Paradigm Metals Limited**
Graham Carman - Managing Director
- 2.50pm **Drummond Gold Limited**
Doug Grewar - Managing Director
- 3.10pm Afternoon Tea**
- 3.50pm **Goldminex Resources Limited**
Basil Tambanis - Managing Director
- 4.10pm **Thundelarra Exploration Limited**
Brett Lambert - Managing Director
- 4.30pm **Victoria Petroleum NL**
John Kopcheff - Managing Director
- 4.50pm **Gippsland Limited**
Jack Telford - Executive Chairman
- 5.10pm **Bondi Mining Limited**
Dr Rick Valenta - Managing Director
- 5.30pm **Conference Drinks in the Exhibition Area**
- 6.30pm **Patersons Securities Cocktail Party**
Jade Buddha Shadow Lounge



Day 2 - THURSDAY 30 OCTOBER, 2008

AUDITORIUM 1

- 8.45am **Minemakers Limited**
Andrew Drummond - Managing Director
- 9.05am **Diatreme Resources Limited**
Tony Fawdon - Executive Chairman & CEO
- 9.25am **Bringing Forward Discovery in the Northern Territory**
Dr Ian Scrimgeour - Director, Geological Survey
Northern Territory Government
- 9.35am **New Geoscience Information and New Understanding for Mineral Systems in Western Australia**
Dr Tim Griffin - Executive Director
Geological Survey of Western Australia
- 9.45am **Navigator Resources Limited**
Tom Sanders - Managing Director
- 10.05am **Copper Strike Limited**
Tom Eadie - Managing Director

10.25am **Morning Tea**

- 10.55am **Deep Yellow Limited**
Dr Leon Pretorius - Managing Director
- 11.15am **Metallica Minerals Limited**
Andrew Gillies - Managing Director
- 11.35am **Tasmania: New Developments in Exploration and Mining**
Dr Geoff Green - Managing Geologist
Mineral Resources Tasmania
- 11.45am **PACE and South Australia's pipeline of new mines**
Dr Ted Tyne - Director, Mineral Resources Group,
Division of Minerals and Energy Resources
PIRSA
- 11.55am **Minotaur Exploration Limited**
Dr Tony Belperio - Exploration Director
- 12.15pm **Gold Aura Limited**
Ken Chapple - Managing Director

12.35pm **Lunch**

- 1.35pm **Kagara Limited**
Kim Robinson - Chairman
- 1.55pm **Rediscover Victoria's Potential**
Paul McDonald - Manager, Resources, GeoScience Victoria
Minerals and Petroleum Division
Department of Primary Industries, Victoria
- 2.05pm **Frontier Opportunities in New South Wales**
John Watkins - Assistant Director, Regional Mapping &
Exploration Geoscience
*Department of Primary Industries -
Mineral Resources, NSW*
- 2.15pm **Orocobre Limited**
Richard Seville - Managing Director
- 2.35pm **Reed Resources Limited**
Chris Reed - Managing Director
- 2.55pm **Southern Uranium Limited**
John Anderson - Managing Director

3.15pm **Afternoon Tea**

- 3.50pm **Breakaway Resources Limited**
David Hutton - Exploration Manager
- 4.10pm **Apex Minerals NL**
Mark Ashley - Managing Director
- 4.30pm **Independence Group NL**
Christopher Bonwick - Managing Director
- 4.50pm **Mincor Resources NL**
Steve Cowle - Chief Operating Officer
- 5.10pm **Troy Resources NL**
John Jones - Chairman
- 5.30pm **Troy Resources & Western Areas Cocktail Party**
held in the Exhibition Area

AUDITORIUM 2

- 8.45am **Rex Minerals Limited**
Steve Olsen - Managing Director
- 9.05am **Drake Resources Limited**
Dr Bob Beeson - Managing Director
- 9.25am **Pioneer Nickel Limited**
David Crook - Managing Director
- 9.35am **Golden Rim Resources Limited**
Craig Mackay - Managing Director
- 9.45am **Malachite Resources NL**
Dr Garry Lowder - Managing Director
- 10.05am **Liberty Resources Limited**
Andrew Haythorpe - Managing Director

10.25am **Morning Tea**

- 10.55am **Ironbark Gold Limited**
Jonathan Downes - Managing Director
- 11.15am **Cortona Resources Limited**
Peter van der Borgh - Managing Director
- 11.35am **Arafura Resources Limited**
Richard Brescianini - General Manager, Strategic
Development & Exploration
- 11.45am **Jaguar Minerals Limited**
Nanette Anderson - Managing Director
- 11.55am **Queensland Ores Limited**
Taff Greenwood - Managing Director
- 12.15pm **Shaw River Resources Limited**
Vincent Algar - Managing Director

12.35pm **Lunch**

- 1.35pm **Syndicated Metals Limited**
Russell Davis - Managing Director
- 1.45pm **Anchor Resources Limited**
Trevor Woolfe - Managing Director
- 1.55pm **Superior Resources Limited**
Ken Harvey - Managing Director
- 2.05pm **Opal Horizon Limited**
David Horton - Managing Director
- 2.15pm **Peak Resources Limited**
Mark Maine - Managing Director
- 2.35pm **Carpentaria Exploration Limited**
Nick Sheard - Executive Chairman
- 2.55pm **Dioro Exploration NL**
Rhod Grivas - Managing Director & CEO

3.15pm **Afternoon Tea**

- 3.50pm **Icon Resources Limited**
Dr John Bishop - Managing Director
- 4.10pm **Western Metals Limited**
George Bauk - Managing Director
- 4.30pm **Fusion Resources Limited**
David Berrie - Managing Director
Robert Waugh - Exploration Manager
- 4.50pm **Diamonex Limited**
Dan O'Neill - Managing Director
- 5.10pm **Auditorium Close**
- 5.30pm **Troy Resources & Western Areas Cocktail Party**
held in the Exhibition Area

Day 3 - FRIDAY 31 OCTOBER, 2008

AUDITORIUM 1

- 8.50am **Southern Cross Goldfields Limited**
Tony Truelove - Managing Director
- 9.10am **Heron Resources Limited**
Mathew Longworth - Managing Director
- 9.30am **Ivanhoe Australia Limited**
Peter Reeve - Chief Executive Officer
- 9.50am **Energy Metals Limited**
Lindsay Dudfield - Executive Director
- 10.10am Morning Tea**
- 10.40am **Citigold Corporation Limited**
Mark Lynch - CEO and Managing Director
- 11.00am **China Yunnan Copper Australia**
Jason Beckton - Managing Director
- 11.20am **Cloncurry Metals Limited**
Simon Finnis - Chief Executive Officer
- 11.40am **Sipa Resources Limited**
Michael Doepel - Managing Director
- 12.00pm Lunch**
- 1.10pm **D'Aguilar Gold Limited**
Nicholas Mather - Managing Director
- 1.30pm **Heemskirk Consolidated Limited**
Peter Bird - Executive Director
- 1.50pm **Universal Resources Limited**
Peter Ingram - Chairman and Managing Director
- 2.10pm **Highlands Pacific Group Limited**
John Gooding - Managing Director
- 2.30pm **Aditya Birla Minerals Limited**
Steven Oxenburgh - Group Exploration Manager
- 2.50pm Afternoon Tea**
- 3.20pm **Arrow Energy Limited**
Shaun Scott - Chief Executive Officer (Australia)
- 3.40pm **Aquila Resources Limited**
Andrew Matheson - General Manager (Coal)
- 4.00pm **Hancock Prospecting Pty Ltd**
Tad Watroba - Director
- 4.20pm **Conference Close**

QRC BREAKFAST PRESENTATION

Friday 31 October, 2008 - 7.15am to 8.30am

'Exploring Queensland, the future is NOW'

Hear the latest developments surrounding minerals and energy exploration and discovery in Queensland, brought to you by the Queensland Resources Council.

Join us for breakfast at the Tattersall's Club, corner Edward and Queen Streets, Brisbane.

Ticket cost is \$35.00 per person (inc GST) and can be booked through the QRC - Book now to avoid disappointment by visiting

www.qrc.org.au and click on Events Calendar.



AUDITORIUM 2

AusIMM Forum on Coal



- 8.50am **Metgasco Limited**
David Johnson - Managing Director
- 9.10am **Bow Energy Limited**
John De Stefani - CEO, LNG and Commercial
- 9.30am **Cougar Energy Limited**
Dr Len Walker - Managing Director
- 9.50am **Carbon Energy Limited**
Cliff Mallett - Executive General Manager
- 10.10am Morning Tea**
- 10.40am **Northern Energy Corporation Limited**
Keith Barker - Managing Director
- 11.00am **Waratah Coal Inc**
Peter Lynch - President and CEO
- 11.20am **Rey Resources Limited**
Kevin Wilson - Managing Director
- 11.40am **Longwall Top Coal Caving**
Frank Fulham - General Manager, Austar Coal Mine
- 12.10pm Lunch**
- 1.10pm **Underground Continuous Haulage**
Peter Seear - Chief Operating Officer
Caledon Resources plc
- 1.40pm **An Australian Emissions Trading Scheme: its Likely Impacts on the Coal Mining Sector**
Stuart Dix - Principal
E3 International Pty Ltd
- 2.10pm **Successful Crisis Management**
Scott Malson - Development Manager
Molopo Australia Limited
- 2.50pm Afternoon Tea**
- 3.20pm **Infrastructure Panel Discussion**

Patrick Quirk - Director of Ports, Planning and GOC Liaison - Rail, Ports and Freight Division
Queensland Transport

Greg Smith - General Manager Operations
BBI (DBCT) Management Pty Ltd

Ross Dunning
Central Coordinator for the Goonyella Coal Chain
- 4.20pm **Conference Close**



EXHIBITOR LISTING - ALPHABETICAL

A1 Minerals Ltd	64
Activex Ltd	56
Aditya Birla Minerals Ltd	77
Alliance Resources Ltd	40
Apex Minerals NL	5
Arafura Resources Ltd	57
Ausenco Services Pty Ltd	45
Australasian Resources Ltd	6
Australian Laboratory Services	63
Auzex Resources Ltd	69
Bellevue Resources Ltd	14
Bloomberg LP	11
Bondi Mining Ltd	31
Breakaway Resources Ltd	18
Carpentaria Exploration Ltd	37
Citigold Corporation Ltd	38
Cloncurry Metals Ltd	17
Coffey Mining	8
Copper Strike Ltd	80
CRU	58
D'Aguilar Gold Ltd	3
Department of Mines and Energy QLD	21
Department of Mines and Energy QLD	36
Department of Mines and Energy QLD	PC1
Diatreme Resources Ltd	13
Economic Geology Research Unit (EGRU)	29
Encom	53
Fugro Airborne Surveys Pty Ltd	46
Galaxy Resources Ltd	43
Genalysis Laboratory Services	28
Geological Survey of Western Australia	19
Geoscience Australia	22
GeoScience Victoria	23
Glengarry Resources Ltd	16
Gold Aura Ltd	65
Golder Associates Pty Ltd	41
Golding Contractors Pty Ltd	59
Highlands Pacific Group Ltd	9
HRL Testing Pty Ltd	76
Icon Resources Ltd	27
IMC Mining Solutions	48
Innov-X Australia	47
Integra Mining Ltd	70
Intierra Ltd	50
ioGlobal	54
Ironbark Gold Ltd	34
Ivanhoe Australia Ltd	10
Japan Oil, Gas and Metals National Corporation	12
Kagara Ltd	71
Krucible Metals Ltd	55
Liberty Resources Ltd	81
McCullough Robertson - Lawyers	75
Metallica Minerals Ltd	7
Micromine Pty Ltd	74
Mincor Resources Ltd	68
Minemakers Ltd	32
Mineral Resources Tasmania	26
Mining Associates Pty Ltd	82
Mining People International	PC2
Minotour Exploration Ltd	73
Navigator Resources Ltd	1
Northern Territory Government	25
NSW Department of Primary Industries	20
Opal Horizon Ltd	30
Orocobre Ltd	39
PanAust Ltd	15
Patersons Securities Ltd	35
Peak Resources Ltd	51
PIRSA	24
Rapid Crushing & Screening Contractors	66
Reed Resources Ltd	33
RSV Australia Pty Ltd	49
SGS Advanced Mineralogy Facility	60
Snowden	44
Southern Uranium Ltd	4
Stock Resource	67
Superior Resources Ltd	30
Syndicated Metals Ltd	79
Terra Search Pty Ltd	72
Thundelarra Exploration Ltd	52
Trafford Resources Ltd	2
TWP Australia Pty Ltd	61
Universal Resources Ltd	42
Venture Minerals Ltd	78
Victoria Petroleum NL	62

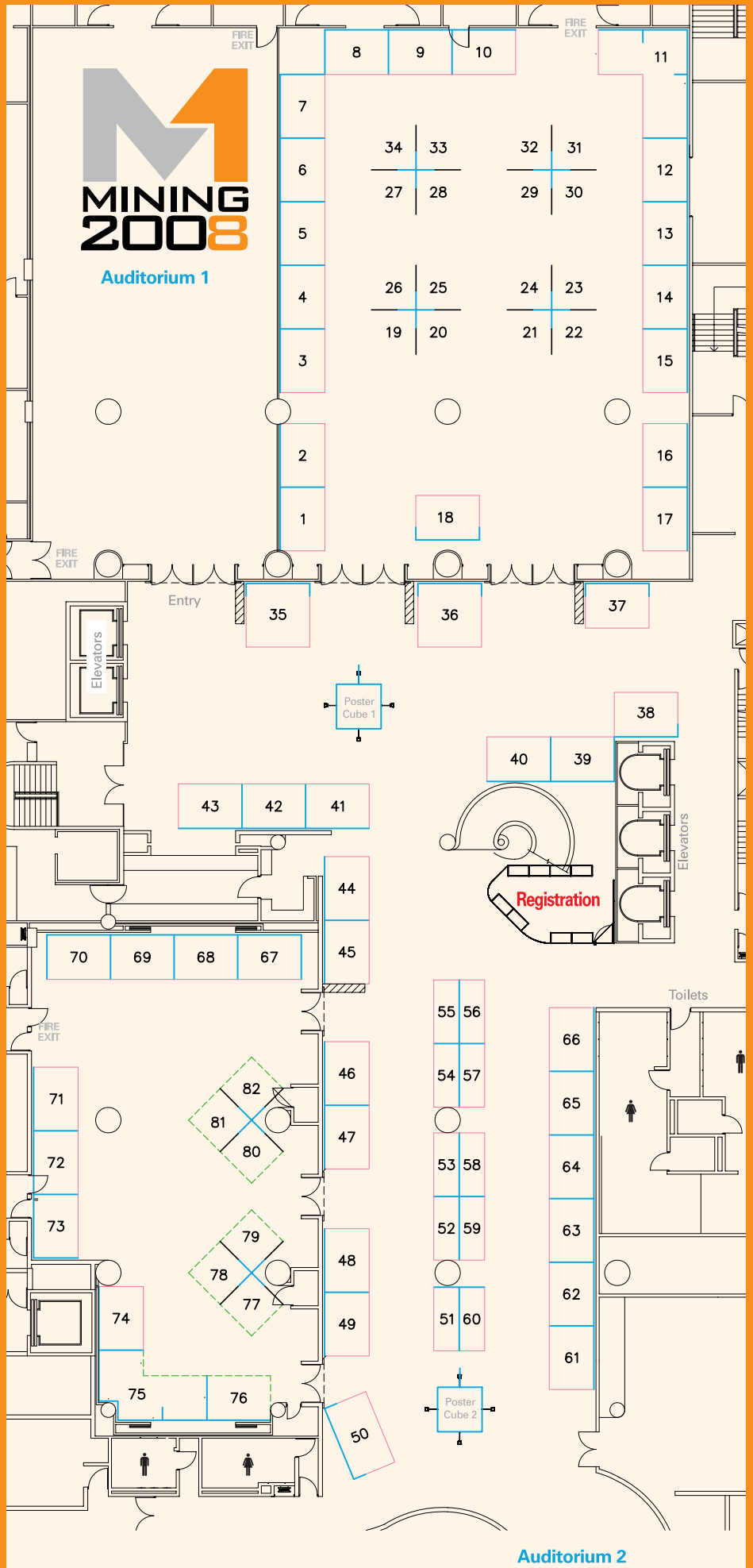



AUSTRALIA'S ONLY
INTEGRATED MINING
AND ENERGY
INVESTMENT FORUM

BRISBANE ... THE TRADITION CONTINUES

GOLD SPONSORS



SILVER SPONSORS



COMPANY SPONSORS



MEDIA SPONSOR



PRESENTED BY



IN ASSOCIATION WITH



MINING 2000

ABN: 86 083 623 358

PO Box 1153, Subiaco WA 6904
Suite 15, 186 Hay Street,
Subiaco WA 6008

T: (08) 9388 2222

F: (08) 9381 9222

E: info@verticalevents.com.au

W: www.verticalevents.com.au