



AUSTRALIA'S ONLY
INTEGRATED MINING
AND ENERGY
INVESTMENT FORUM



THE MINING 2008 RESOURCES CONVENTION

29-31 OCTOBER, 2008

HILTON BRISBANE HOTEL
QUEENSLAND - AUSTRALIA

CONFERENCE PROGRAM

BRISBANE

... THE TRADITION CONTINUES



GOLD SPONSORS



SILVER SPONSORS



COMPANY SPONSORS



MEDIA SPONSOR



PRESENTED BY



IN ASSOCIATION WITH





Invitation to attend

It is with pleasure that we present the program for the Mining 2008 Resources Convention to be held at the Hilton Brisbane Hotel on 29 to 31 October, 2008.

Queensland is the place to be right now for explorers, with new discoveries and competition for new and existing mineral and energy resources.

There have been numerous announcements about mineral exploration and development activity as well as significant developments in the coal seam gas sector. The Queensland Government's Smart Exploration and Smart Mining Future Prosperity data acquisition programs are paying dividends with a surge in exploration activity in key regions of the State.

In July 2005 in the North-West Queensland Mineral Province (Mount Isa region), there were 411 granted EPMs covering 49,000 square kilometres and 214 EPM applications covering 39,000 square kilometres. By June 2008, following the release of Smart Exploration geophysical data, many research projects, the positive impacts of the Collaborative Drilling, Cluster Formation and Industry Network Initiatives plus the strategy of creating and repealing Restricted Areas, there has been an enormous surge in exploration activity in the area, with 733 granted EPMs covering 118,000 square kilometres and 597 EPM applications covering 119,000 square kilometres.

This is an increase in area of granted and application EPMs of 168% in just under three years. The Mount Isa region has the attention of the global exploration industry.

The area is hot, with ongoing exploration announcements by Kings Minerals, Copper Co, Cudoco and others, and significant resource upgrade announcements including Perylia's Mount Oxide project. Elsewhere in Queensland, Conquest's Mount Carlton project is shaping as a significant gold, silver and copper resource.

A similar story could be presented for the increased activity for coal seam gas, coal and oil and gas in the Bowen and Surat Basins. The coal and coal seam gas industries are booming and exploration and resource definition activity has ramped up significantly with several proposals on the drawing board for LNG production facilities.

Investment Focus

Every conference is different and Brisbane is no exception. We cover mining and energy companies, issues relating specifically to Queensland and most importantly investment.

We are working hard to provide the conference with a series of high net worth individuals for the purpose of investing in the resources industry and will be transporting investors to the event from the Gold Coast and Sunshine Coast as well as working with investment groups within Brisbane.

The Mining 2008 Resources Convention is a vital part of the Australia Resources calendar and is relevant, focused and most of all enjoyable!

We look forward to seeing you there.

Yours sincerely

Stewart McDonald
Managing Director - Vertical Events

BRISBANE

... THE TRADITION CONTINUES



VENUE

Hilton Brisbane Hotel

190 Elizabeth Street
Brisbane QLD 4001
Telephone: 07 3234 2000



The Hilton Brisbane overlooking Queen Street Mall is Brisbane's Premier Deluxe Hotel.

Ideally positioned, the Hotel is adjacent to the major Shopping and Entertainment districts, Southbank Parklands, Queensland Performing Arts Centre, Botanic Gardens and Convention Centre are all within a short stroll.

The Hilton's modern architecture boasts a dramatic atrium soaring 25 floors above the lobby, with all accommodation levels opening onto the atrium.

ACCOMMODATION

Hilton Brisbane Hotel

KING HILTON DELUXE ROOM rates from \$245 per night

Wake up to this modern 32m²/344sq.ft room with a city view, seating area and high-speed internet. Work in comfort at the large desk with ergonomic chair, stretch out on the sofa, de-stress with the Sony PlayStation or re-energize in the marble bathroom.

KING EXECUTIVE ROOM rates from \$315 per night

Enjoy this contemporary 32m²/344sq.ft room offering city view, working and seating areas and Executive Lounge access with free breakfast and refreshments. The bright and airy room has 1 king bed. Surf the web with high-speed internet, put your feet up in the large armchair with ottoman, de-stress with the Sony PlayStation or refresh in the marble bathroom.

Bookings can be made at the Hilton by visiting the Vertical Events website and following the ACCOMMODATION link at www.verticalevents.com.au/mining2008

The Sebel & Citigate Hotel - 7 min walk

King George Square (cnr Ann & Roma Sts, Brisbane)

CITIGATE KING GEORGE SQUARE TOWER

(4 star) with standard, contemporary designed rooms - \$200 per room per night.

SEBEL KING GEORGE SQUARE TOWER

(5 star) with larger, classically furnished, deluxe rooms \$240 per room per night.

Carparking is available for inhouse guests at a cost of \$22 per car per night.

Please mention the Mining 2008 Resources Convention when making your booking with Reservations on (07) 3229 9111.

The Manor Apartment Hotel

(289 Queen St, Brisbane) is offering the following room rates for a 1 Bedroom Apartment for \$195 per room per night (includes continental breakfast) or a 2 Bedroom Apartment for \$295 per room per night (includes continental breakfast for up to four people).

Please contact Andrew Buckley in Reservations on (07) 3319 4700 and mention you are attending the Mining 2008 Resources Convention when making your booking.

* All accommodation bookings are in accordance with the hotels cancellation policy. All rooms are strictly subject to availability. Please note all rates and room types are subject to availability at the time of booking and are quoted in Australian dollars.



SOCIAL FUNCTIONS

Tuesday 28 October 2008 – 6.30pm to 8.30pm – Riverside Centre, 123 Eagle Street, Brisbane

Snowden Welcome Reception

Snowden will once again be hosting the Mining 2008 Welcome Reception at the Riverside Centre on Tuesday 28 October.

Join industry colleagues and friends over cocktails and canapés, to view the best of Snowden's annual photography competition "Celebrating the Mining Industry".

Please contact Anna McKersey on amckersey@snowdengroup.com for further information and to confirm your attendance.

SNOWDEN

www.snowdengroup.com

Wednesday 29 October 2008 - 6.30pm to 8.30pm – Jade Buddha Shadow Lounge

Patersons Securities Cocktail Party

As a major sponsor of the Mining 2008 Resources Convention, Patersons Securities is pleased to host the Patersons Cocktail Party, incorporating the inaugural Mining 2008 Awards.

Please join us for drinks from 6.30 – 8.30pm at the Jade Buddha Shadow Lounge to celebrate another successful year in mining.

Following the pre-function drinks at the Hilton, please make your way to Jade Buddha, 1 Eagle St, Brisbane.

 **PATERSONS**

Thursday 30 October 2008 - 5.30pm to 7.30pm

Mining 2008 Cocktail Party

To be held in the exhibition area at the Hilton Hotel.

Sponsored by Troy Resources NL and Western Areas NL.



TROY RESOURCES NL



The social event for members and friends of the mining community is on again!

Come to the Mining Ball, have a great time, and help support the Royal Flying Doctor Service of Australia.

The Mining Ball will be held in conjunction with the Mining 2008 Resources Convention so that our interstate colleagues can attend. It's a great opportunity to share a good time with your partner, your staff, clients, customers and their partners, and celebrate the important role they all play in our great Industry.

Your ticket includes a premium three-course dinner with beverages, entertainers 'Aussie Legends', a seven-piece band 'osKar' and a door prize. Snowden's photo exhibition competition entries and winners will also be on display, with some of the best ones up for auction.

Come and join us for this communal celebration of our Industry through fine food, great wine, outstanding entertainment and dancing!

To book OR secure corporate sponsorship, please contact Cheryl on (07) 3832 9999 or email ckearney@srk.com.au

Tickets for the ball can also be purchased from Vertical Events at a cost of \$190 per person (inc gst)



*WHERE: Plaza Ballroom
Brisbane Convention &
Exhibition Centre, corner
Merivale & Glenelg Sts,
South Brisbane Qld*

DATE: 31 October 2008

TIME: 7.00pm for 7.30pm

DRESS: Evening

RSVP: 10 October 2008

*Be there and support the
Royal Flying Doctor Service!*

Day 1 - WEDNESDAY 29 OCTOBER, 2008

AUDITORIUM 1

- 8.40am **Welcome Address**
Stewart McDonald - Managing Director
Vertical Events
- 8.45am **Queensland Government Address**
- 9.00am **Market Update**
Mark Simpson - Head of Research
Patersons Securities Limited
- 9.20am **Will Inflation Bring the Mining Boom to an End?**
Justin Smirk - Senior Economist
Westpac Institutional Bank
- 9.40am **CRU Mineral Commodities Outlook - Red Hot or Stone Cold?**
Allan Trench - Regional Director, Australasia
CRU | Analysis
- 10.00am **Energy in Australia: Recent Developments and Future Prospects**
Paul Balfe - Executive Director
ACIL Tasman Pty Ltd
- 10.20am **Morning Tea**
- 11.00am **Queensland Energy Exploration Expansion**
Peter Green - Manager Exploration Strategies
Department of Mines and Energy, QLD
- 11.15am **Smart Exploration Successes**
David Mason - Executive Director,
Geological Survey of Queensland
Department of Mines and Energy, QLD
- 11.30am **New Insights into the Controls on Zn-Pb, Cu and U Mineralisation in the Mt Isa and Georgetown Inliers**
Dr David Huston - Project Leader, Onshore Energy and Minerals Division
Geoscience Australia
- 11.55am **Lihir Gold Limited**
Graham Folland - General Manager Corporate Development
- 12.15pm **Western Areas NL**
Julian Hanna - Managing Director
- 12.35pm **Lunch**
- 1.40pm **Matrix Metals Limited**
Shane McBride - Managing Director
- 2.00pm **Auzex Resources Limited**
John Lawton - Executive Chairman
- 2.10pm **Australasian Resources Limited**
Andrew Caruso - Managing Director
- 2.30pm **Integra Mining Limited**
Chris Cairns - Managing Director
- 2.50pm **Alliance Resources Limited**
Steve Johnston - Chief Executive Officer
- 3.10pm **Afternoon Tea**
- 3.50pm **Trafford Resources Limited**
Ian Finch - Managing Director
- 4.10pm **Krucible Metals Limited**
Tony Alston - Managing Director
- 4.30pm **CopperCo Limited**
Brian Rear - Managing Director
- 4.50pm **Vital Metals Ltd**
Andrew Haslam - Managing Director
- 5.10pm **PanAust Limited**
Dr Fred Hess - Executive General Manager Southeast Asia
- 5.30pm **Conference Drinks in the Exhibition Area**
- 6.30pm **Patersons Securities Cocktail Party**
See Social Functions for further details

AUDITORIUM 2

- 11.00am **The Great Years Ahead**
Helen Sava - National Secretary
Association of Independent Retirees
- 11.15am **Resources - Where to Now?**
Grant Craighead - Managing Director
Stock Resource
- 11.35am **BC Iron Limited**
Mike Young - Managing Director
- 11.55am **Gunson Resources Limited**
David Harley - Managing Director
- 12.15pm **Image Resources NL**
George Sakalidis - Managing Director
- 12.35pm **Lunch**
- 1.40pm **Laramide Resources Limited**
Rob Sowerby - Senior Project Geologist
- 2.00pm **Venture Minerals Limited**
Andrew Radonjic - Managing Director
- 2.10pm **Warwick Resources Limited**
Bruce McQuitty - Managing Director
- 2.30pm **Paradigm Metals Limited**
Graham Carman - Managing Director
- 2.50pm **Clancy Exploration Limited**
Mark Stewart - Managing Director
Gordon Barnes - Exploration Manager
- 3.10pm **Afternoon Tea**
- 3.50pm **Goldminex Resources Limited**
Basil Tambanis - Managing Director
- 4.10pm **Thundelarra Exploration Limited**
Brett Lambert - Managing Director
- 4.30pm **Victoria Petroleum NL**
John Kopcheff - Managing Director
- 4.50pm **Gippsland Limited**
Jack Telford - Executive Chairman
- 5.10pm **Bondi Mining Limited**
Dr Rick Valenta - Managing Director
- 5.30pm **Conference Drinks in the Exhibition Area**
- 6.30pm **Patersons Securities Cocktail Party**
See Social Functions for further details



Day 2 - THURSDAY 30 OCTOBER, 2008

AUDITORIUM 1

- 8.45am **Minemakers Limited**
Andrew Drummond - Managing Director
- 9.05am **Diatreme Resources Limited**
Tony Fawdon - Executive Chairman & CEO
- 9.25am **Bringing Forward Discovery in the Northern Territory**
Northern Territory Government
- 9.35am **New Geoscience Information and New Understanding for Mineral Systems in Western Australia**
Dr Tim Griffin - Executive Director
Geological Survey of Western Australia
- 9.45am **Navigator Resources Limited**
Tom Sanders - Managing Director
- 10.05am **Vulcan Resources Limited**
Alistair Cowden - Managing Director

10.25am Morning Tea

- 10.55am **Deep Yellow Limited**
Dr Leon Pretorius - Managing Director
- 11.15am **Metallica Minerals Limited**
Andrew Gillies - Managing Director
- 11.35am **Tasmania: New Developments in Exploration and Mining**
Dr Geoff Green - Managing Geologist
Mineral Resources Tasmania
- 11.45am **PACE and South Australia's pipeline of new mines**
Dr Ted Tyne - Director, Mineral Resources Group, Division of Minerals and Energy Resources
PIRSA
- 11.55am **Minotaur Exploration Limited**
Dr Tony Belperio - Exploration Director
- 12.15pm **Gold Aura Limited**
Ken Chapple - Managing Director

12.35pm Lunch

- 1.35pm **Kagara Limited**
Kim Robinson - Chairman
- 1.55pm **Rediscover Victoria's Potential**
Richard Aldous - Executive Director, Minerals and Petroleum Division
Department of Primary Industries, Victoria
- 2.05pm **Frontier Opportunities in New South Wales**
John Watkins - Assistant Director, Regional Mapping & Exploration Geoscience
Department of Primary Industries - Mineral Resources, NSW
- 2.15pm **Orocobre Limited**
Richard Seville - Managing Director
- 2.35pm **Reed Resources Limited**
Chris Reed - Managing Director
- 2.55pm **Southern Uranium Limited**
John Anderson - Managing Director

3.15pm Afternoon Tea

- 3.50pm **Breakaway Resources Limited**
Peter Buck - Managing Director
- 4.10pm **Apex Minerals NL**
Mark Ashley - Managing Director
- 4.30pm **Independence Group NL**
Christopher Bonwick - Managing Director
- 4.50pm **Mincor Resources NL**
David Moore - Managing Director
- 5.10pm **Troy Resources NL**
John Jones - Chairman
- 5.30pm **Troy Resources & Western Areas Cocktail Party**
held in the Exhibition Area

AUDITORIUM 2

- 8.45am **Rex Minerals Limited**
Steve Olsen - Managing Director
- 9.05am **Drake Resources Limited**
Dr Bob Beeson - Managing Director
- 9.25am **Pioneer Nickel Limited**
David Crook - Managing Director
- 9.35am **Golden Rim Resources Limited**
Craig Mackay - Managing Director
- 9.45am **Malachite Resources NL**
Dr Garry Lowder - Managing Director
- 10.05am **Copper Strike Limited**
Tom Eadie - Managing Director

10.25am Morning Tea

- 10.55am **Ironbark Gold Limited**
Jonathan Downes - Managing Director
- 11.15am **Cortona Resources Limited**
Peter van der Borgh - Managing Director
- 11.35am **Arafura Resources Limited**
Richard Brescianini - General Manager, Strategic Development & Exploration
- 11.45am **Jaguar Minerals Ltd**
Nanette Anderson - Managing Director
- 11.55am **Queensland Ores Limited**
Taff Greenwood - Managing Director
- 12.15pm **First Australian Resources Limited**
Michael Evans - Chairman

12.35pm Lunch

- 1.35pm **Syndicated Metals Limited**
Russell Davis - Managing Director
- 1.45pm **Anchor Resources Limited**
Trevor Woolfe - Managing Director
- 1.55pm **Superior Resources Limited**
Ken Harvey - Managing Director
- 2.05pm **Opal Horizon Limited**
David Horton - Managing Director
- 2.15pm **Peak Resources Limited**
Mark Maine - Managing Director
- 2.35pm **Carpentaria Exploration Limited**
Nick Sheard - Executive Chairman
- 2.55pm **Dioro Exploration NL**
Rhod Grivas - Managing Director & CEO

3.15pm Afternoon Tea

- 3.50pm **Icon Resources Limited**
Dr John Bishop - Managing Director
- 4.10pm **Western Metals Limited**
George Bauk - Managing Director
- 4.30pm **Fusion Resources Limited**
David Berrie - Managing Director
Robert Waugh - Exploration Manager
- 4.50pm **Diamonex Limited**
Dan O'Neill - Managing Director
- 5.10pm **Shaw River Resources Limited**
Vincent Algar - Managing Director
- 5.30pm **Troy Resources & Western Areas Cocktail Party**
held in the Exhibition Area

DAY 3 - FRIDAY 31 OCTOBER, 2008

AUDITORIUM 1

- 8.50am **Southern Cross Goldfields Limited**
Tony Truelove - Managing Director
- 9.10am **Heron Resources Limited**
Mathew Longworth - Managing Director
- 9.30am **Ivanhoe Australia Limited**
Peter Reeve - Chief Executive Officer
- 9.50am **Energy Metals Limited**
Lindsay Dudfield - Executive Director
- 10.10am Morning Tea**
- 10.40am **Citigold Corporation Limited**
Mark Lynch - CEO and Managing Director
- 11.00am **China Yunnan Copper Australia**
Jason Beckton - Managing Director
- 11.20am **Cloncurry Metals Limited**
Simon Finnis - Chief Executive Officer
- 11.40am **Sipa Resources Limited**
Michael Doepel - Managing Director
- 12.00pm Lunch**
- 1.10pm **D'Aguilar Gold Limited**
Nicholas Mather - Managing Director
- 1.30pm **Heemskirk Consolidated Limited**
Peter Bird - Executive Director
- 1.50pm **Universal Resources Limited**
Peter Ingram - Chairman and Managing Director
- 2.10pm **Highlands Pacific Group Limited**
John Gooding - Managing Director
- 2.30pm **Aditya Birla Minerals Limited**
Steven Oxenburgh - Group Exploration Manager
- 2.50pm Afternoon Tea**
- 3.20pm **Arrow Energy Limited**
Shaun Scott - Chief Executive Officer (Australia)
- 3.40pm **Aquila Resources Limited**
Andrew Matheson - General Manager (Coal)
- 4.00pm **Hancock Prospecting Pty Ltd**
Tad Watroba - Director
- 4.20pm **Conference Close**

QRC BREAKFAST PRESENTATION

Friday 31 October, 2008 - 7.15am to 8.30am

'Exploring Queensland, the future is NOW'

Hear the latest developments surrounding minerals and energy exploration and discovery in Queensland, brought to you by the Queensland Resources Council.

Join us for breakfast at the Tattersall's Club, corner Edward and Queen Streets, Brisbane.

Ticket cost is \$35.00 per person (inc GST) and can be booked through the QRC - Book now to avoid disappointment by visiting

www.qrc.org.au and click on Events Calendar.



AUDITORIUM 2

AusIMM Forum on Coal



- 8.50am **Metgasco Limited**
David Johnson - Managing Director
- 9.10am **Bow Energy Limited**
Ron Prefontaine - Managing Director
- 9.30am **Cougar Energy Limited**
Dr Len Walker - Managing Director
- 9.50am **Carbon Energy Limited**
Cliff Mallett - Executive General Manager
- 10.10am Morning Tea**
- 10.40am **Northern Energy Corporation Limited**
Keith Barker - Managing Director
- 11.00am **Waratah Coal Inc**
Peter Lynch - President and CEO
- 11.20am **Rey Resources Limited**
Kevin Wilson - Managing Director
- 11.40am **Longwall Top Coal Caving**
- 12.10pm Lunch**
- 1.10pm **Underground Continuous Haulage**
Peter Seear - Chief Operating Officer
Caledon Resources plc
- 1.40pm **An Australian Emissions Trading Scheme: its Likely Impacts on the Coal Mining Sector**
Stuart Dix - Principal
E3 International Pty Ltd
- 2.10pm **Successful Crisis Management**
- 2.50pm Afternoon Tea**
- 3.20pm **Infrastructure Panel Discussion**
Includes representatives from Dalrymple Bay Coal Terminal and Queensland Transport
- 4.20pm **Conference Close**



MEDIA

Some of the leading resources / finance journalists from around Australia are being flown in for the Mining 2008 Resources Convention, further demonstrating that this event has become one of the leading resource investment conferences in Australia.

Media Sponsor



All Media enquires should be directed to David Tasker, PPR WA on 08 9388 0944.

Professional
Public Relations



MINING 2008 PASSPORT

The Mining Passport is a great way to win fantastic prizes and find out more about some of the exhibitors at the conference.

Simply visit one of the ten booths on the passport, write your answer to the printed question and receive your stamp. Once you have finished your journey place the completed passport in specially marked boxes at the entrances to each auditorium.

Passports can be found in your conference satchel or are available at the Registration Desk. Winners will be announced before the afternoon tea break on Friday 31 October, 2008.

Passport Sponsor



NEW AWARDS FOR 2008

The Mining 2008 Resources Convention is pleased to announce the introduction of two awards for this year's event:

- the 2008 QLD Explorer of the Year
- the 2008 QLD Miner of the Year

Both awards will be presented in recognition of excellence in the state's minerals sector and the outstanding contribution it is making towards Queensland's powerhouse economic growth.

The awards will be officially presented at the Patersons Securities Cocktail Party on Wednesday 29 October at the Jade Buddha Shadow Lounge. Winners will be decided by a team of experts and previewed in the October edition of the Gold & Minerals Gazette (an RIU publication).

CHINA MINING 2008

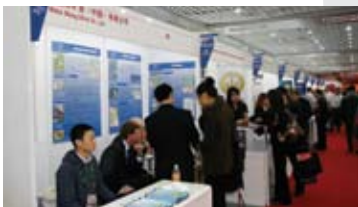

CHINA MINING 中国国际矿业大会

As one of the world's TOP 4 mining conferences, the CHINA MINING Congress provides the best channel and platform for mining companies to communicate and exchange new ideas. Issues such as development, investment policies, mining rights trading, exploration, technology and equipment, mining evaluation and consultancy and sustainable development are to be discussed. Last year, the CHINA MINING Congress attracted over 300 exhibitors, 10,000 professional visitors and 3,000 conference delegates from 45 countries.

The CHINA MINING Congress has four main parts - an exhibition (CHINA MINING EXPO), forum gala awards dinner and featured events. It has become a truly global mining event.

Date: November 11-13, 2008

Venue: Beijing International Convention Center (BICC)

For more information on this event or to be part of the Australian Pavilion please contact Doug Bowie (Australian Agent for CHINA MINING) on +618 9388 2222 or email doug@verticalevents.com.au



EXHIBITOR LISTING - ALPHABETICAL

A1 Minerals Ltd	64
Activex Ltd	56
Aditya Birla Minerals Ltd	77
Alliance Resources Ltd	40
Apex Minerals NL	5
Arafura Resources Ltd	57
Ausenco Services Pty Ltd	45
Australasian Resources Ltd	6
Australian Laboratory Services	63
Auzex Resources Ltd	69
Bloomberg LP	11
Bondi Mining Ltd	31
Breakaway Resources Ltd	18
Citigold Corporation Ltd	38
Cloncurry Metals Ltd	17
Coffey Mining	8
Copper Strike Ltd	80
CRU	58
D'Aguilar Gold Ltd	3
Department of Mines and Energy QLD	21
Department of Mines and Energy QLD	36
Department of Mines and Energy QLD	PC1
Diatreme Resources Ltd	13
Economic Geology Research Unit (EGRU)	29
Encom	53
First Australian Resources Ltd	66
Fugro Airborne Surveys Pty Ltd	46
Genalysis Laboratory Services	28
Geological Survey of Western Australia	19
Geoscience Australia	22
GeoScience Victoria	23
Glengarry Resources Ltd	16
Gold Aura Ltd	65
Golder Associates Pty Ltd	41
Golding Contractors Pty Ltd	59
Highlands Pacific Group Ltd	9
HRL Testing Pty Ltd	76
Icon Resources Ltd	27
IMC Mining Solutions	48
Innov-X Australia	47
Integra Mining Ltd	70
Intierra Ltd	50
ioGlobal	54
Ironbark Gold Ltd	34
Japan Oil, Gas and Metals National Corporation	12
Kagara Ltd	71
Krucible Metals Ltd	55
Liontown Resources Ltd	10
Matrix Metals Ltd	14
McCullough Robertson - Lawyers	75
Metallica Minerals Ltd	7
Micromine Pty Ltd	74
Mincor Resources Ltd	68
Minemakers Ltd	32
Mineral Resources Tasmania	26
Mining Associates Pty Ltd	82
Mining People International	PC2
Minotour Exploration Ltd	73
Navigator Resources Ltd	1
Northern Territory Government	25
NSW Department of Primary Industries	20
Opal Horizon Ltd	30
Orocobre Ltd	39
PanAust Ltd	15
Patersons Securities Ltd	35
Peak Resources Ltd	51
PIRSA	24
Rapid Crushing & Screening Contractors	43
Reed Resources Ltd	33
RSV Australia Pty Ltd	49
SGS Advanced Mineralogy Facility	60
Snowden	44
Southern Uranium Ltd	4
Stock Resource	67
Superior Resources Ltd	30
Syndicated Metals Ltd	79
Terra Search Pty Ltd	72
Thundelarra Exploration Ltd	52
Trafford Resources Ltd	2
TWP Australia Pty Ltd	61
Universal Resources Ltd	42
Venture Minerals Ltd	78
Victoria Petroleum NL	62
Vital Metals Ltd	37
Vulcan Resources Ltd	81

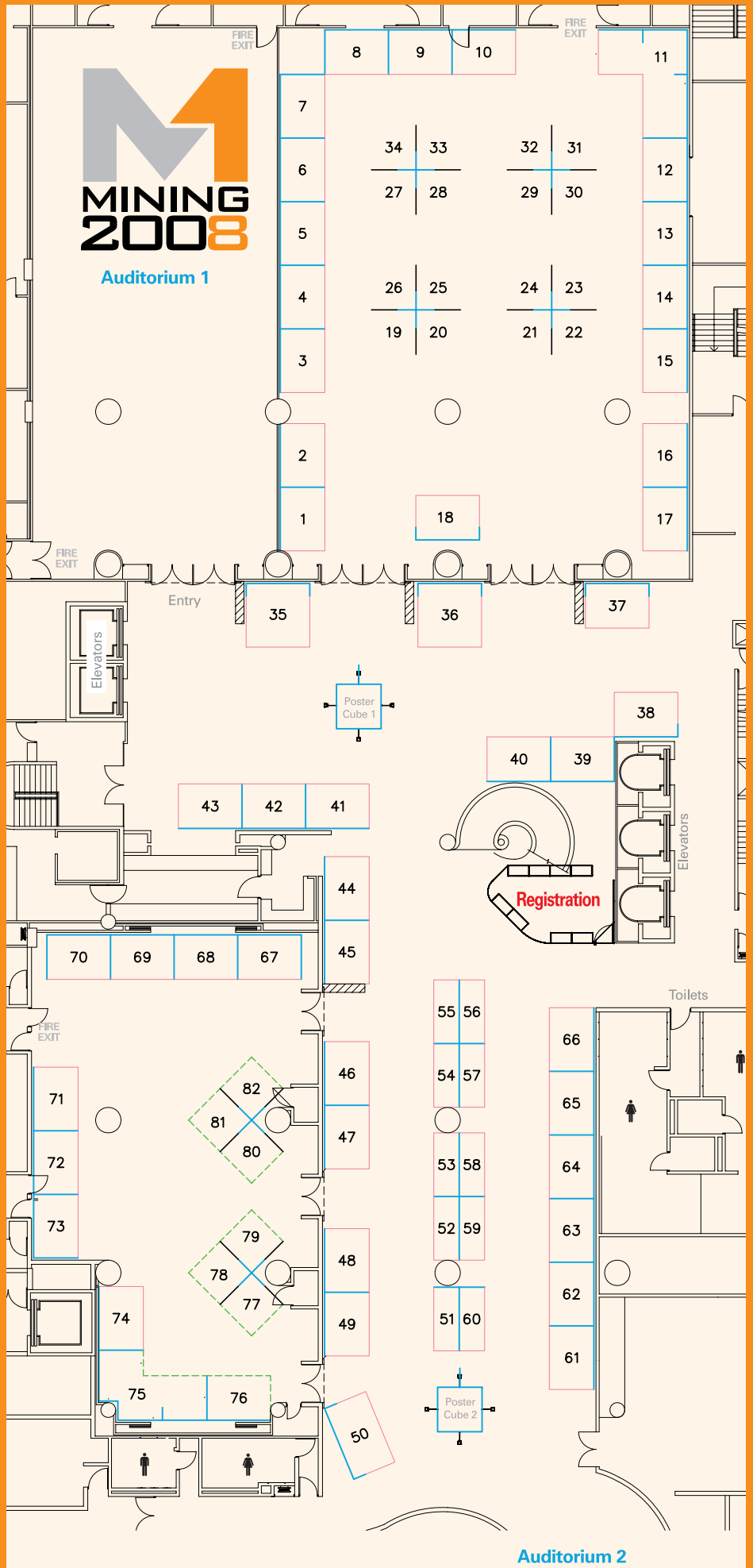

M MINING 2008

29 - 31 OCTOBER, 2008
HILTON BRISBANE - AUSTRALIA

DELEGATE REGISTRATION

Please complete this form and remit together with your payment to the address at the bottom of the page. A separate form must be completed for each delegate (photocopies are acceptable). Registrations will not be processed without full payment.

CONTACT INFORMATION

Title / First Name: _____ Surname: _____

Job Title: _____

Organisation: _____

Address: _____

City / State / Postcode: _____ Country: _____

Telephone: _____ Facsimile: _____

Email: _____

A TAX INVOICE AND CONFIRMATION OF ATTENDANCE WILL BE FAXED TO YOU. ABN: 86 083 623 358

CONFERENCE REGISTRATION

- | | | |
|--------------------------|--|------------------------------|
| <input type="checkbox"/> | Early Bird Registration (before 29 August, 2008) | \$ 990.00 (inclusive of GST) |
| <input type="checkbox"/> | Standard Registration (after 29 August, 2008) | \$1100.00 (inclusive of GST) |
| <input type="checkbox"/> | The Mining Ball 2008 | \$ 190.00 (inclusive of GST) |

Early Bird and Standard Registration includes attendance to the presentation and exhibition areas, lunches and tea breaks each day and attendance to the Conference Cocktail Functions. The Mining Ball and QRC Breakfast Presentation is a separate charge. Each delegate also receives a conference satchel.

PAYMENT OPTIONS

Payment must be received within seven (7) days of verbal reservation. Please return this application to PO Box 1153, Subiaco WA 6904, Australia or alternatively fax to (61 8) 9381 9222. *If paying by cheque, please make payable to Mining 2000 Pty Ltd.*

*Please note a 4% surcharge will be added to all American Express and Diners Charges.

Visa Card Master Card Bankcard American Express* Diners Card*

Card Number: _____

Card Expiry Date: _____ Total to be paid: _____

Cardholder's Name: _____ Cardholder's Signature: _____

AUTHORISATION

Authorisation of this form is a binding contract – including non-arrivals to the event. Please refer to the cancellation policy below.

Name: _____

Position: _____ Signature: _____

CANCELLATION POLICY

Cancellation Policy: All cancellations must be made in writing to Vertical Events. No refunds will be made after 10 October, 2008. All refunds prior to 10 October, 2008 will incur an administration charge.



AUSTRALIA'S ONLY
INTEGRATED MINING
AND ENERGY
INVESTMENT FORUM



MINING 2000 PTY LTD ABN: 86 083 623 358

PO Box 1153, Subiaco WA 6904 - Suite 15, 186 Hay Street, Subiaco WA 6008

T: (08) 9388 2222 F: (08) 9381 9222 E: info@verticalevents.com.au W: www.verticalevents.com.au

